

New generation Seismic Bracing Platform Supports from Bergvik Flooring



- Compact (green) design for shipment
- Easily adaptable to support various types of equipment
- Low weight and speedy installation

9/2/2010



Seismic Platform 2.0 – comparison with older model



- Weight -46%
- Install.time -50%
- Price -50%

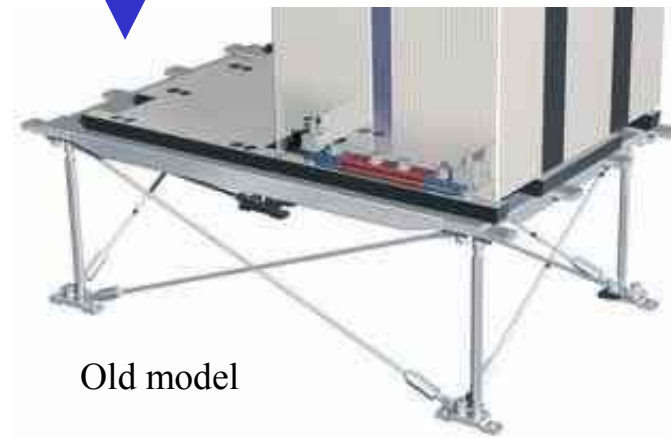

Old model

Integration with Iso Floor raised floor

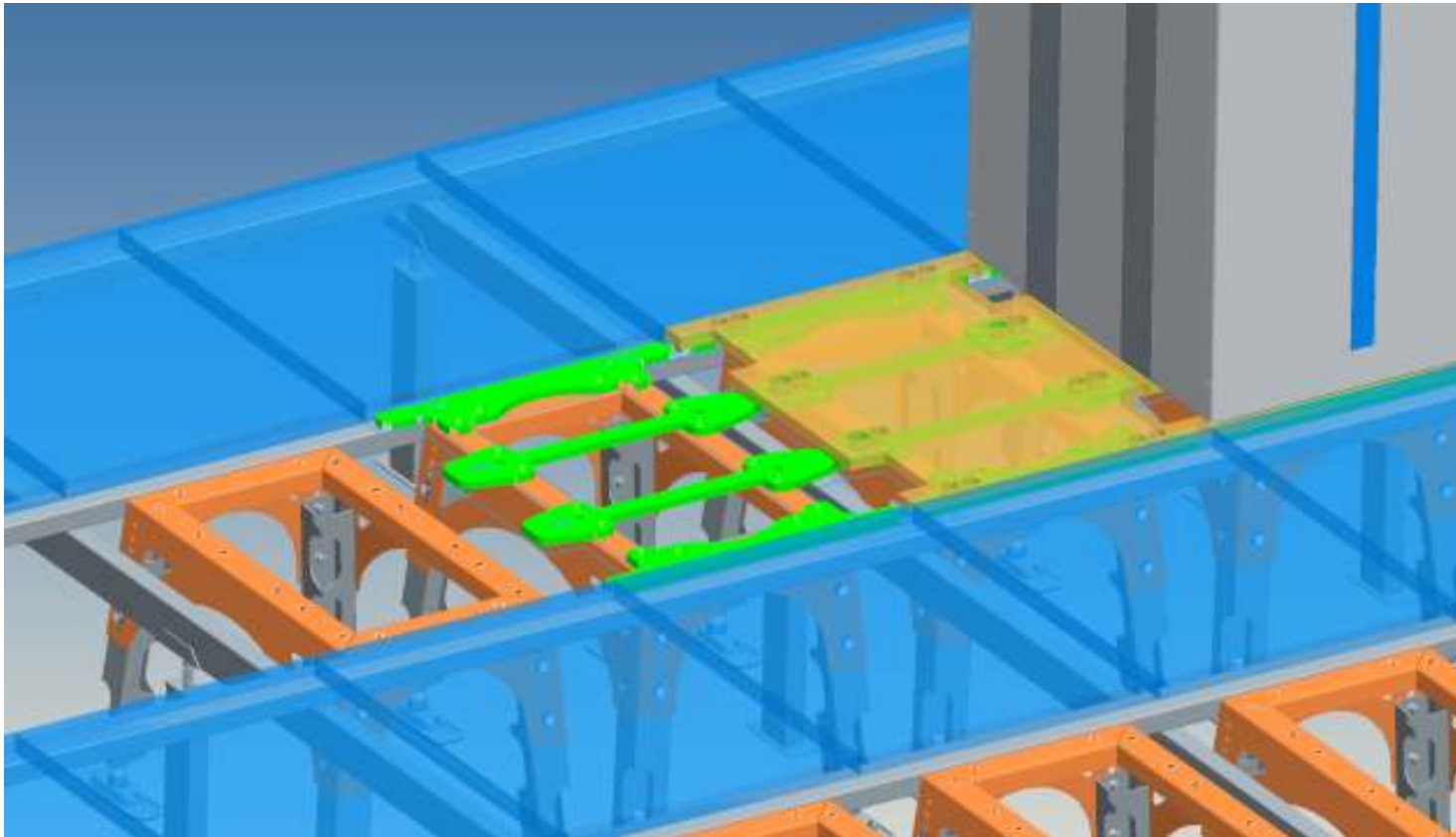

9/2/2010

Integration with Iso Floor raised floor, continue

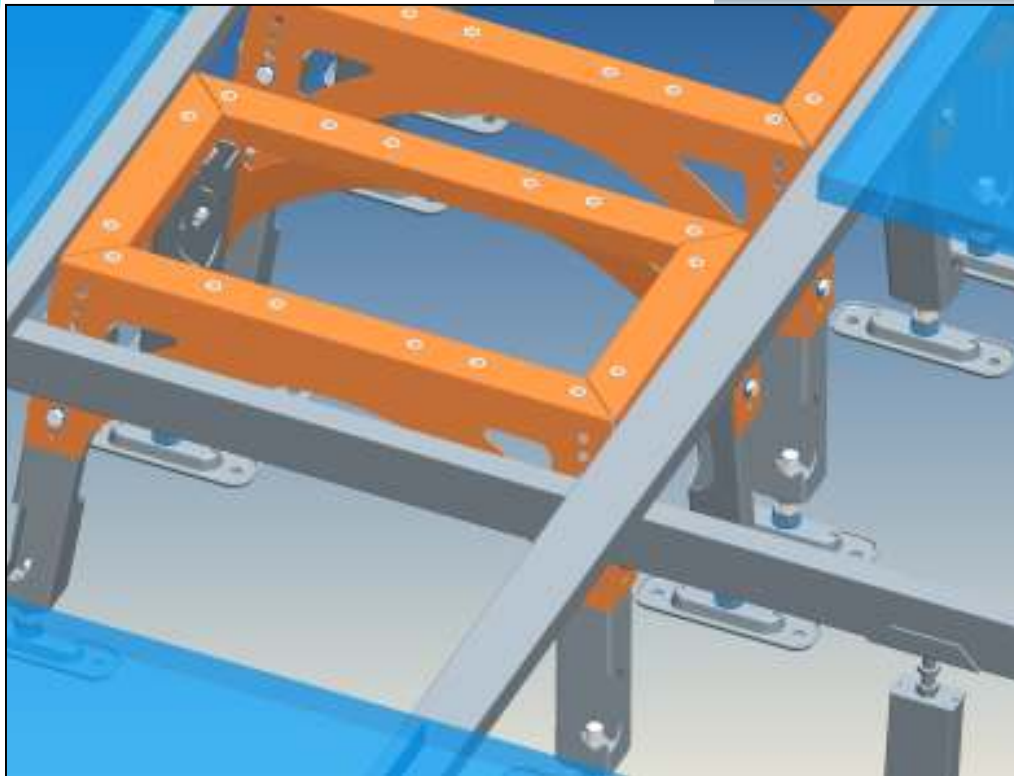
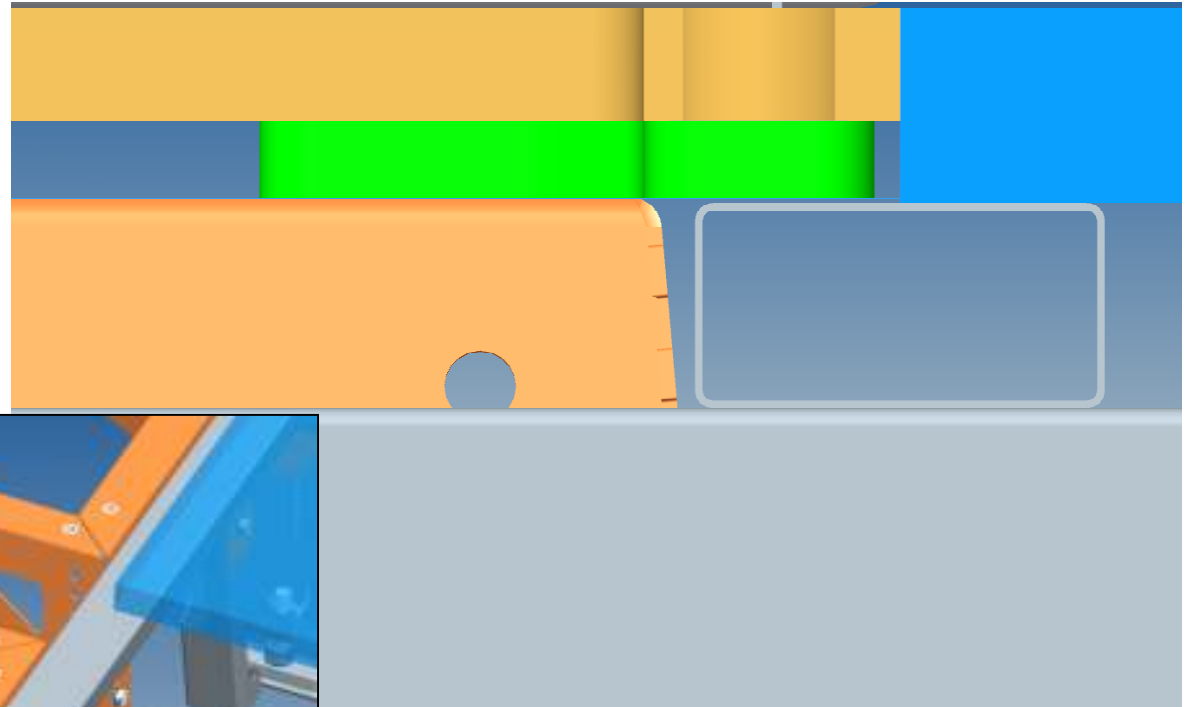

A flat pack design in your color

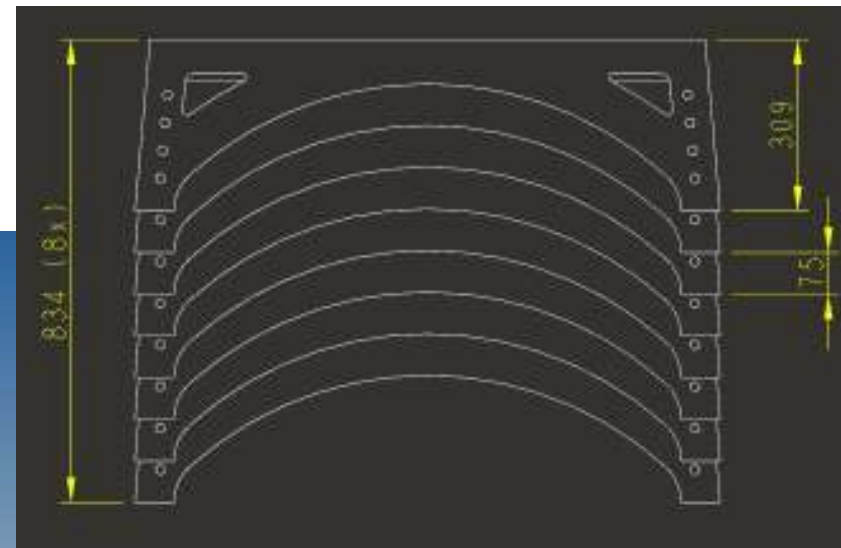
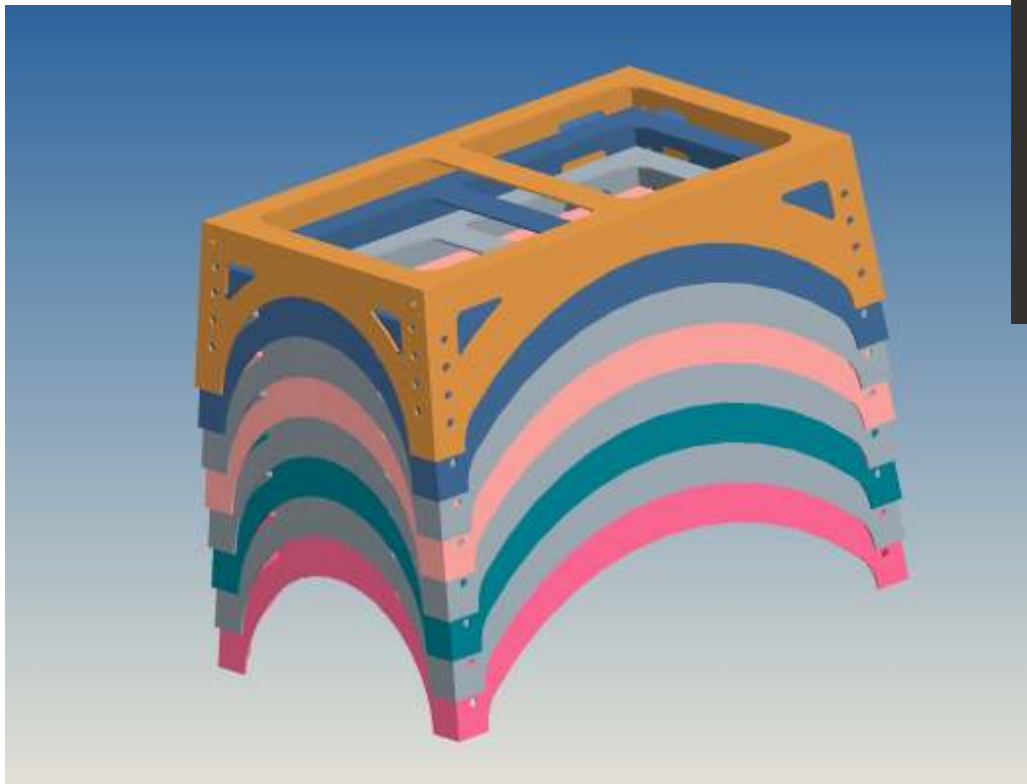

Specification Bergvik Seismic Frame 2.0

All Seismic Bracing Frames from Bergvik are tested to NEBS standards for seismic zone 4 and designed specifically to fit the equipment mounted on them. Seismic Bracing Frames are delivered partly pre-assembled.

- **Gross weight:** 75-125 kg/m² floor area.
- **Finished floor height:** 350 to 915 mm.
- **Loading capacity:** 17,5 kN/m²
- **Tested according to:** NEBS GR 63 zone 4 and NEBS GR 2930.

Floor Panel cover (if needed)

- **Material:** 38 mm moist resistant particle board.
- **Size:** Sizes are adapted to each specific frame.
- **Laminate Decor:** M335 Granit as standard.

